

LEO v2
Wall-Mounted Type
Installation Guide



Indoor Environmental Quality

Table of Contents

- 1. Product Components ----- 3
- 2. Dimension ----- 4
- 3. Management target ----- 5
- 4. How to install ----- 6
- 5. Product specification ----- 7
- 6. Cautions ----- 8
- 7. Safety Precautions ----- 9
- 8. Warranty ----- 10

1. Product Components

Part 1. Sensor Device

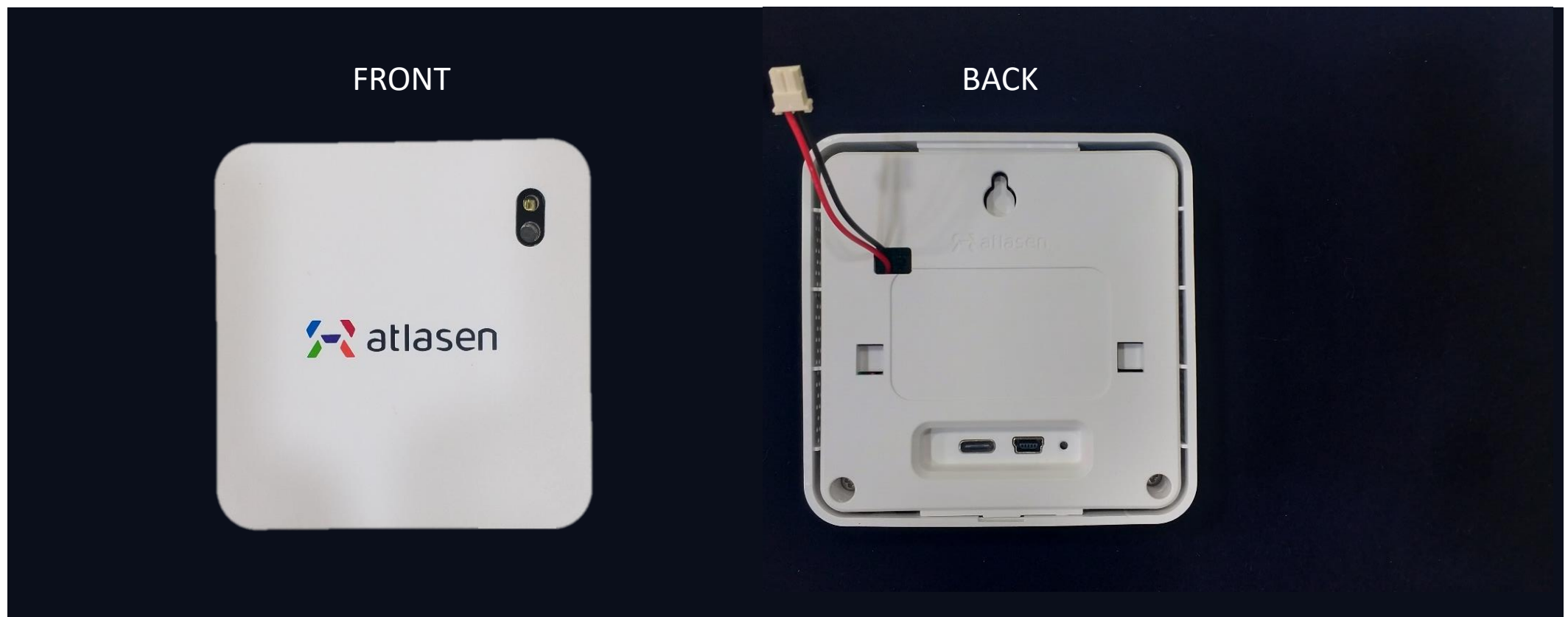

Part 2. AC/DC Converter



2. Dimension

Sensor: 94*94*25 mm

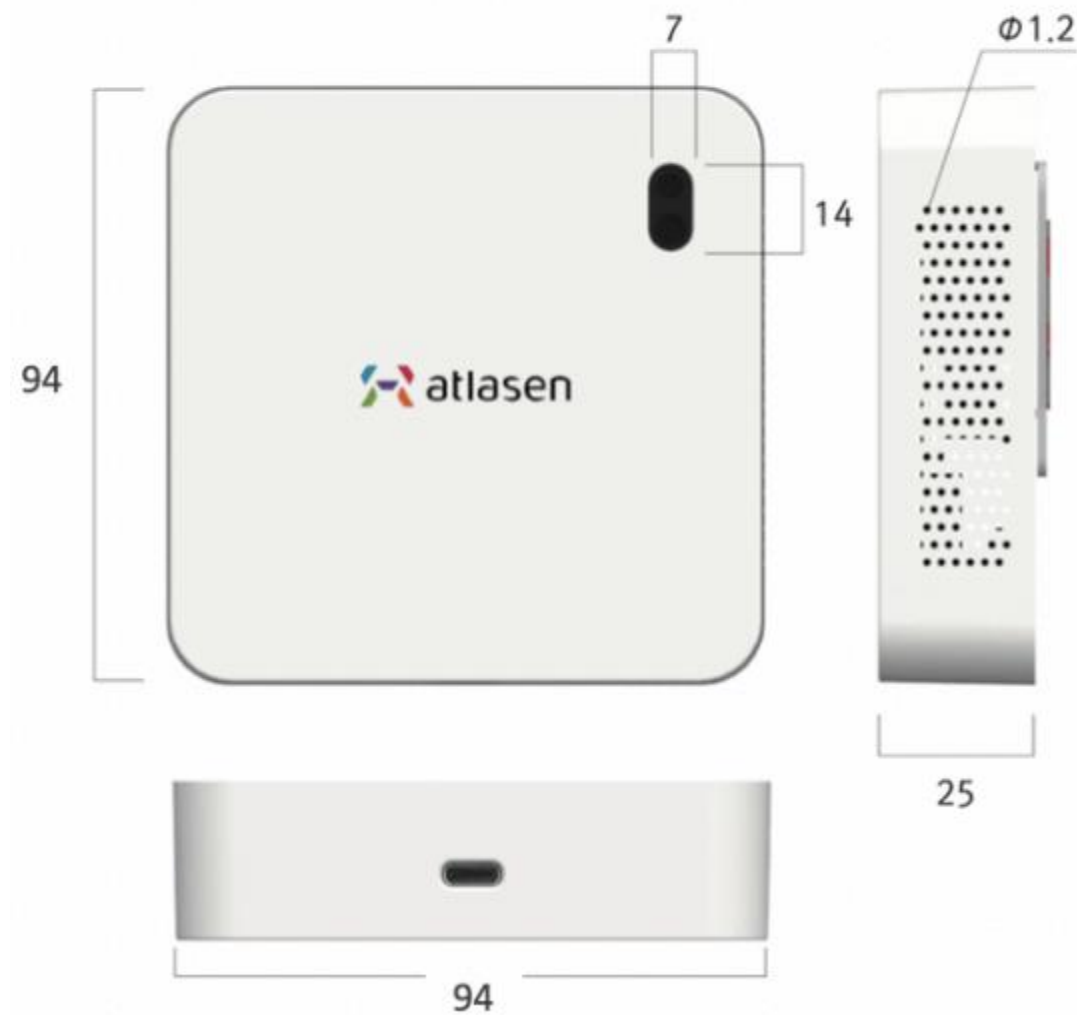

Junction Box: 86*86*50 mm



Product: Wall Mounted Internal Junction Box
Material: PVC
Size: length 86mm, width 86mm, depth 50mm
Mounting hole distance: 60mm
Mounting holes: 2 EA horizontal
Weight : About 45g

3. Management target

Category	Indicies	
Thermal	1	Temperature
	2	Relative Humidity
Air	3	Carbon Dioxide (CO2)
	4	Carbon monoxide (CO)
	5	Total Volatile Organic Compounds (TVOC)
	6	Particulate Matters (PM10)
	7	Particulate Matters (PM2.5)
	8	Particulate Matters (PM1.0)
	9	Formaldehyde (HCHO)
	10	Ozone (O3)
	11	Nitrogen Dioxide (NO2)
	12	Ammonia (NH3)
	13	Hydrogen Sulfide (H2S)
	14	Sulfur Dioxide (SO2)
Lighting	15	Methane (CH4)
	16	Illuminance (Lux)
Acousitic	17	Sound level (dBA)

4. How to Install

- 1** Install the junction box on the wall

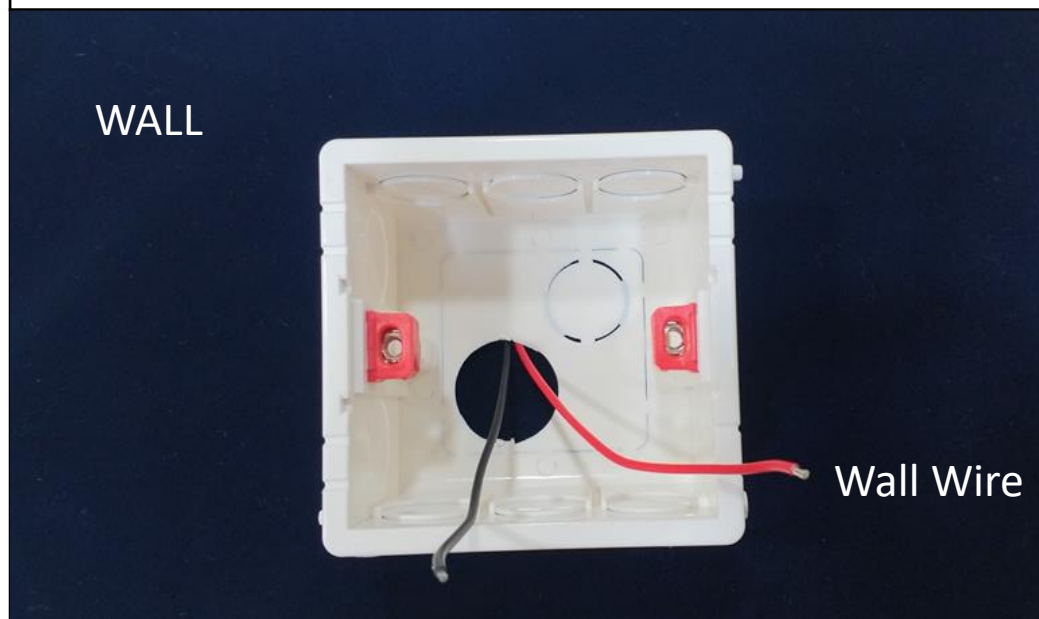

- 2** Connect the wall wires to the WAGO of the Part 2(AC/DC converter)



- 3** Put the Part 2 into the junction box and combine



- 4** Connect the wire of the Part 1(Sensor Device) to Part 2.

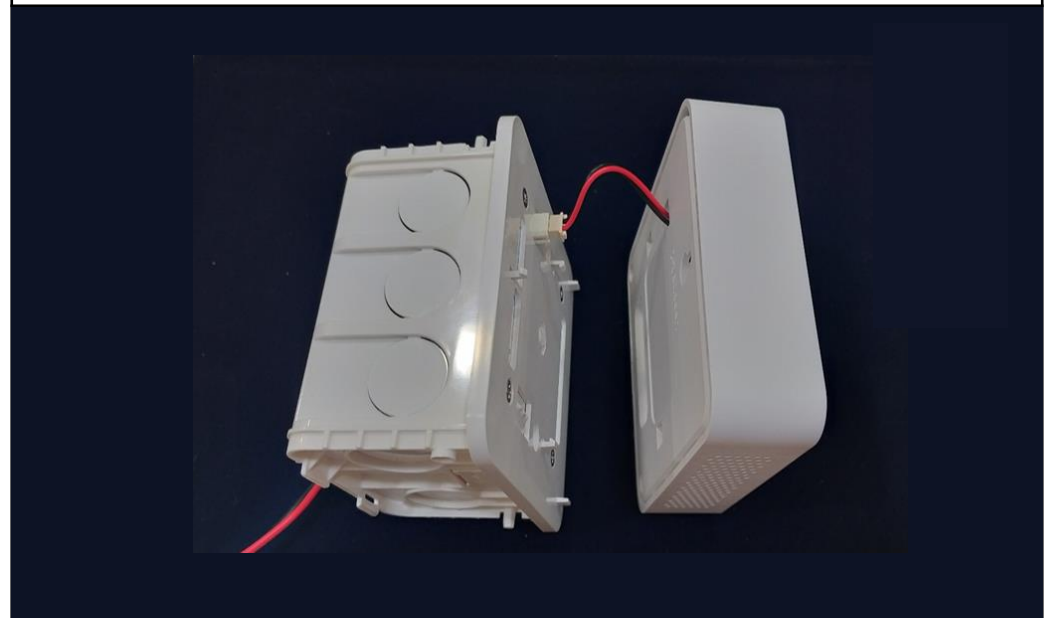

- 5** Fix the Part 1 by fitting it to the clasp

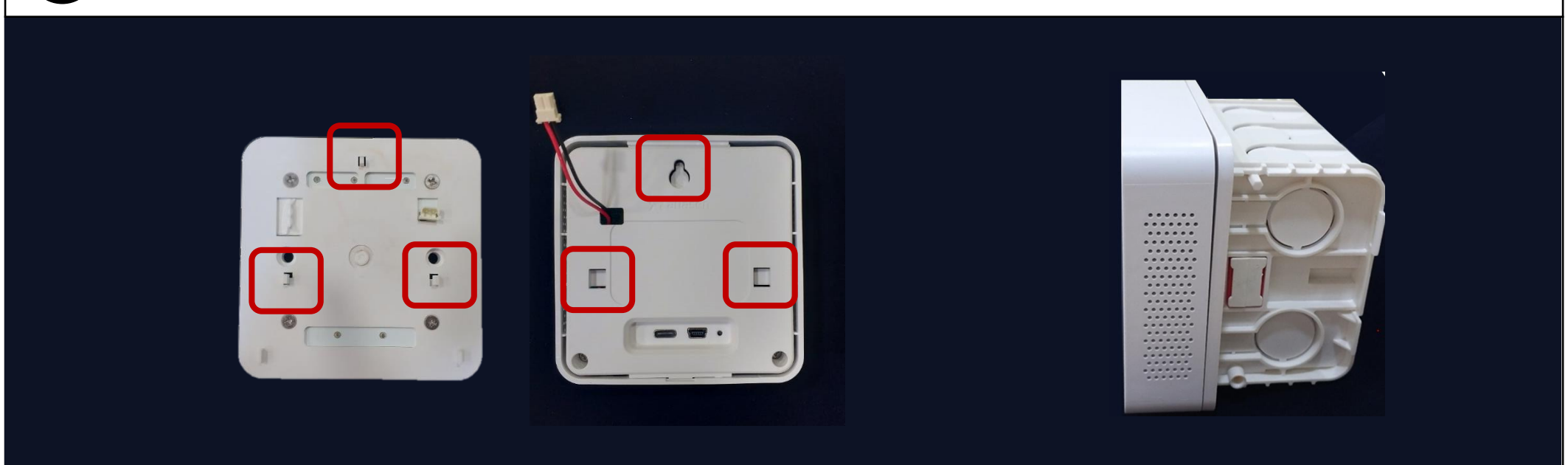

5. Products Specification

Index	Remark
Model No.	LEO v2
Sensor Capacity	Real-time IEQ Monitoring Device
Dimension	Sensor Device: 94*94*25 (mm) AC/DC Converter: 94*94*25 (mm)
Weight	Sensor Device: 130g AC/DC Converter: 100g
Operation Conditions	Temperature: 0 to 50 °C, Humidity: 0 to 95 %
Storage Conditions	Temperature: -20 to 70 °C, Humidity: 0 to 95 %
Warm Up Time @ Switch On	< 20 sec
Power Supply	Input: 100-240Vac, 50-60Hz, 1A Output: 9Vdc/1A, USB Type C
Overvoltage category	II
Pollution degree	2
IoT Connectivity	Wi-Fi: Wi-Fi 802.11 b/g/n (2.4 GHz) Security: WPA/WPA2/WEP/TKIP/AES LoRaWAN, BehrTech MYTHINGS, BACNet RS485/RS422
Analyzing Tool	RESTful, SOAP, SQL, Server Support
Interval	Configurable, Default: 15 min.
System Requirement	Android 4.1 or later, iOS 8 or later atlasencontrol account
Certification	FCC, KC, UL, ULC
Operating Life (Estimated)	5 years

6. Cautions



Cautions

1. This product is for indoor use and is not waterproof.
2. Sensor readings may vary depending on the environment of use, installation, location, calibration execution, etc.
3. Install the product on a level surface. There is a possibility of malfunction when it is used tilted.
4. Internal sensors are sensitive to vibration and shaking, so please install in areas where there is no vibration.
5. Please be careful not to be covered with dust in the vent hole of the sensor case for accurate data measurement.
6. If the outside is contaminated by dust, please remove it with a dry towel.
7. If you open the sensor on your own, there is a risk of failure. Please make sure to consult with the manufacturer.
8. If the LED on the rear panel is green, it is on normal operation;
if it is orange, it is malfunctioning.
If the orange light is shown, unplug the power and operate it again.
If the problem is not resolved, please contact customer service.
(Help Center: hello@atlasen.com)
9. In the case of malfunction or error, please contact customer service.

7. Safety Precautions



Safety Precautions

1. Avoid use in outdoor or condensed environments.
2. This equipment is permanently used equipment, and there is a risk of accidents if you remove the product on your own after installation.
3. When disassembling for installation and repair, it must be performed by a manager with professional knowledge.
4. Install only in spaces with UL certified Circuit-breaker. When installing or uninstalling, you must power off with Circuit-breaker before working.
5. Circuit-breaker needs to be marked that circuit-breaker can disconnect power for this product.
6. For DC supplied WIRE, it must be connected to a supply wire greater than 18 AWG.
7. The sensor automatically stops operating in the event of a short due to over-current. Power off with Circuit-breaker and then perform uninstallation.
8. Do not disassemble or assemble the product while in use.
9. Please be aware of handling the product, as it may be damaged by falling or external impact.
10. If the accessories (cables or power cables) are damaged or require replacement, please contact us.
11. We are not responsible for any accidents or problems caused by failure to comply with the safety precautions stated above.

8. Warranty

- The warranty period for this product is one year from the date of purchase. In the case of a defect within the warranty period a free repair service will be provided.
- After the warranty period, service will be provided at a cost.
- However, in the case of service provided at a cost under Consumer Damage.
- Compensation Regulations(such as product damage due to user negligence), the service is provided for a fee even during the warranty period.
- For shipping fees, for free of charge service, shipping fees will be charged for both user and provider. For paid services, shipping will be charged on the user.
- This warranty will not be reissued.

Product Name	atlasen IEQ IoT Sensor
Model Name	atlasen LEO
Serial No.	Marked on surface of the case
Date of Purchase	MM-DD-YYYY
Manufacturer /Country of Manufacture	atlasen, Korea
Seller	
Help Center	hello@atlasen.com



Indoor Environmental Quality

CONTACT

Homepage
www.atlasen.com

E-Mail
hello@atlasen.com